

## FW60SX - FW250SX



**Prodotti non adatti a sollevamento persone**  
**Products not suitable for lifting people**

In conformità EN 2006/42/CE - EN 14492-2 - EN 12100-1-2  
 According to EN 2006 42 EC - EN 14492-2 - EN 12100-1-2

Modelli Models		FW 60SX	FW 60SXL	FW 80SX	FW 80SXL	FW 100SX	FW 100SXL	FW 120SX	FW 150SX	FW 180SX	FW 180SXL	FW 220SX
Tiro 1° strato / 1st line pull	daN	600	600	800	800	900	900	1100	1300	1800	1800	2050
Tiro ultimo strato / Last line pull	daN	400	400	500	500	580	580	820	850	1150	1150	1370
Strati fune / Rope layers	n°	6	6	6	6	5	5	5	4	5	5	5
Ø fune / Rope size	mm	6	6	6	6	7	7	7	8	9	9	10
Lunghezza fune / Rope length	m	80	150	80	150	58	128	78	54	78	155	71
Velocità fune / Rope speed	m/min	55	55	50	50	45	45	55	50	32	32	30
Peso / Weight	kg	40	56	43	58	45	60	56	58	83	98	86
Portata max / Max flow	l/min	36	36	36	36	36	36	45	45	60	60	60
Pressione / Pressure	bar	150	150	160	160	170	170	160	170	150	150	160
Motore / Motor	cc/rev	80.3	80.3	80.3	80.3	80.3	80.3	100	100	100	100	100
Coppia motore / Engine torque	Nm	160	160	165	165	170	170	205	208	205	205	210
Coppia al tamburo Max torque on the drum	Nm	805	805	814	814	820	820	1250	1270	2500	2500	2600
Contropress. max sulla linea di ritorno Max back pressure on return line	bar	2	2	2	2	2	2	2	2	2	2	2
Rapporto di riduzione Gear ratio		5,4	5,4	5,5	5,5	5,75	5,75	6,7	7	10,5	10,5	13,8
Pressione completa apertura freno Full opening brake pressure	bar	24	24	24	24	24	24	24	24	25	25	25

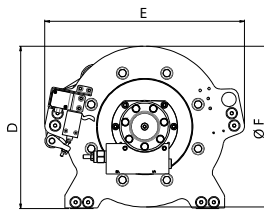

**Senso di Riavvolgimento Fune**  
**Standard - Antiorario**  
**Standard Rope Winding Direction**  
**Counter-Clockwise**

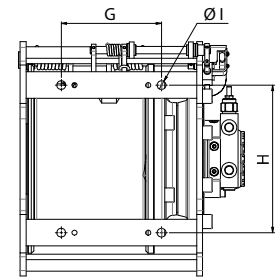
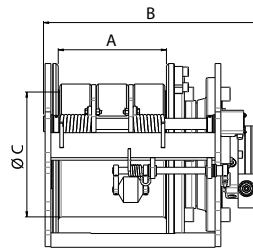

Dimensioni Dimensions		FW 60SX	FW 60SXL	FW 80SX	FW 80SXL	FW 100SX	FW 100SXL	FW 120SX	FW 150SX	FW 180SX	FW 180SXL	FW 220SX
A	mm	136	320	136	320	136	320	158	158	190	372	190
B	mm	289	460	289	460	289	460	346	346	380	560	380
Ø C	mm	180	180	180	180	180	180	210	210	220	220	220
D	mm	261	261	261	261	261	261	286	286	322	322	322
E	mm	318	318	318	318	318	318	343	343	384	384	384
Ø F	mm	258	258	258	258	258	258	286	286	322	322	322
G	mm	170	170	170	170	170	170	170	170	170	364	170
H	mm	250	250	250	250	250	250	250	250	250	250	250
Ø I	mm	15	15	15	15	15	15	15	15	15	15	15

## FW300SX - FW750SX



**Prodotti non adatti a sollevamento persone**  
**Products not suitable for lifting people**

In conformità EN 2006/42/CE · EN 14492-2 · EN 12100-1-2  
 According to EN 2006 42 EC · EN 14492-2 · EN 12100-1-2

Modelli Models		FW 220SXL	FW 250SX	FW 250SXL	FW 300SX	FW 300SXL	FW 350SX	FW 350SXL	FW 450SX	FW 450SXL	FW 550SX	FW 750SX
Tiro 1° strato / 1st line pull	daN	2050	2325	2325	3100	3100	3600	3600	4300	4300	5500	6500
Tiro ultimo strato / Last line pull	daN	1370	1560	1560	2200	2200	2550	2550	2820	2820	4200	5200
Strati fune / Rope layers	n°	5	4	4	5	5	5	5	5	5	5	4
Ø fune / Rope size	mm	10	11	11	13	13	14	14	15	15	16	18
Lunghezza fune / Rope length	m	140	50	98	70	136	62	128	58	120	128	88
Velocità fune / Rope speed	m/min	30	28	28	34	34	32	32	30	30	38	36
Peso / Weight	kg	100	87	102	129	155	136	160	140	165	340	360
Portata max / Max flow	l/min	60	60	60	75	75	75	75	75	75	130	130
Pressione / Pressure	bar	160	180	180	175	175	185	185	195	195	260	280
Motore / Motor	cc/rev	100	100	100	100	100	100	100	100	100	45	45
Coppia motore / Engine torque	Nm	210	230	230	220	220	220	220	220	220	150	160
Coppia al tamburo Max torque on the drum	Nm	2600	2700	2700	5500	5500	5500	5500	5500	5500	12300	12300
Contropress. max sulla linea di ritorno Max back pressure on return line	bar	2	2	2	2	2	2	2	2	2	2	2
Rapporto di riduzione Gear ratio		13,8	15,1	15,1	27,2	27,2	27,3	27,3	27,5	27,5	92,0	92,2
Pressione completa apertura freno Full opening brake pressure	bar	25	25	25	33	33	33	33	33	33	19	19

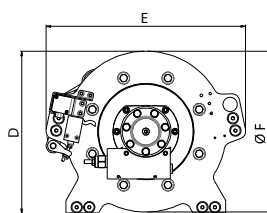

**Senso di Riavvolgimento Fune**  
**Standard - Antiorario**

**Standard Rope Winding Direction**  
**Counter-Clockwise**

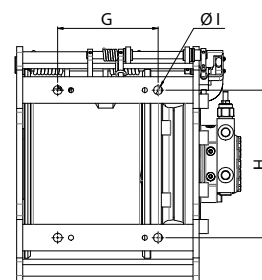
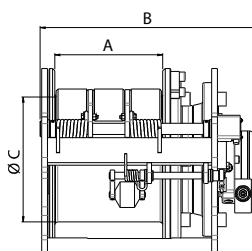

Dimensioni Dimensions		FW 220SXL	FW 250SX	FW 250SXL	FW 300SX	FW 300SXL	FW 350SX	FW 350SXL	FW 450SX	FW 450SXL	FW 550SX	FW 750SX
A	mm	372	190	372	213	413	213	413	213	413	352	352
B	mm	560	380	560	495	690	495	690	495	690	700	700
Ø C	mm	220	220	220	250	250	250	250	250	250	323	323
D	mm	322	322	322	404	404	404	404	404	404	500	500
E	mm	384	384	384	470	490	470	490	470	490	580	580
Ø F	mm	322	322	322	400	400	400	400	400	400	500	500
G	mm	364	170	364	245	245	245	245	245	245	380	380
H	mm	250	250	250	360	360	360	360	360	360	410	410
Ø I	mm	15	15	15	19	19	19	19	19	19	19	19